

RevNo	Revision note	Date	Signature	Checked
2	GENERAL REVISION	9/7/19	IP	IP

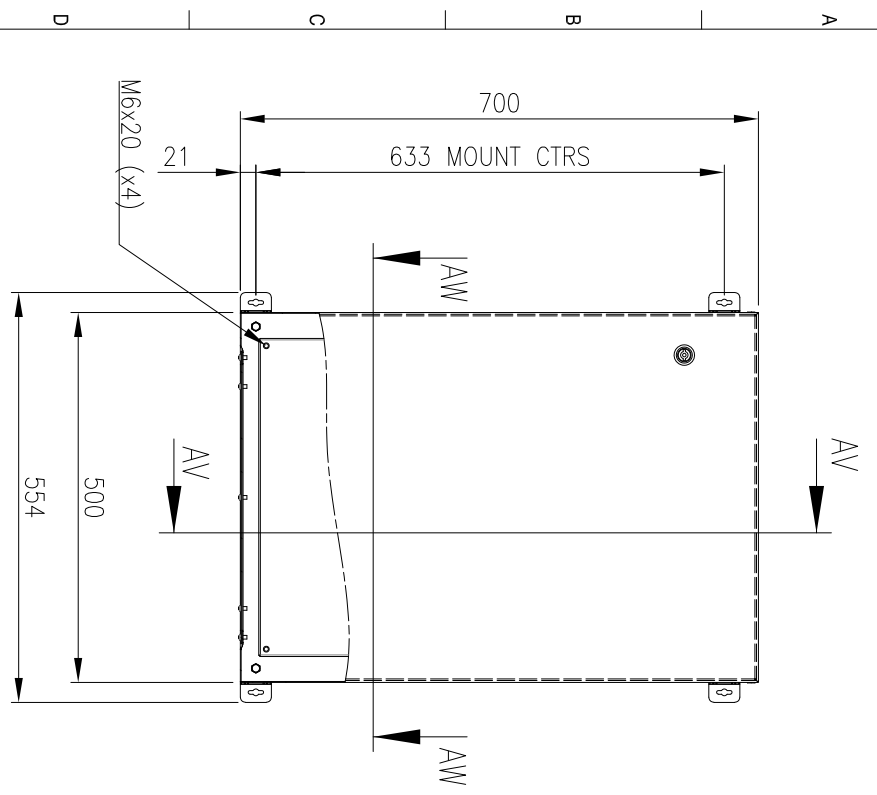

FRONT VIEW

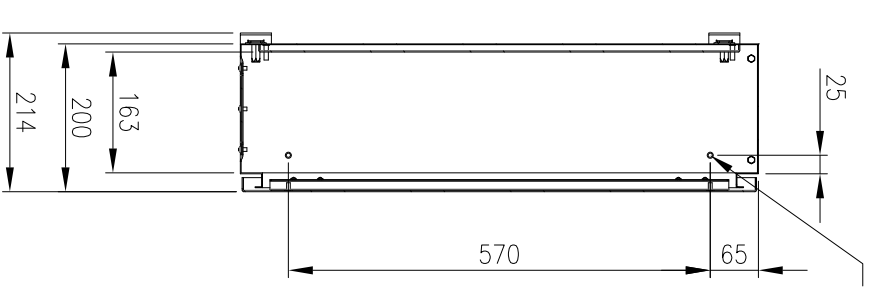

SECTION AV-AV

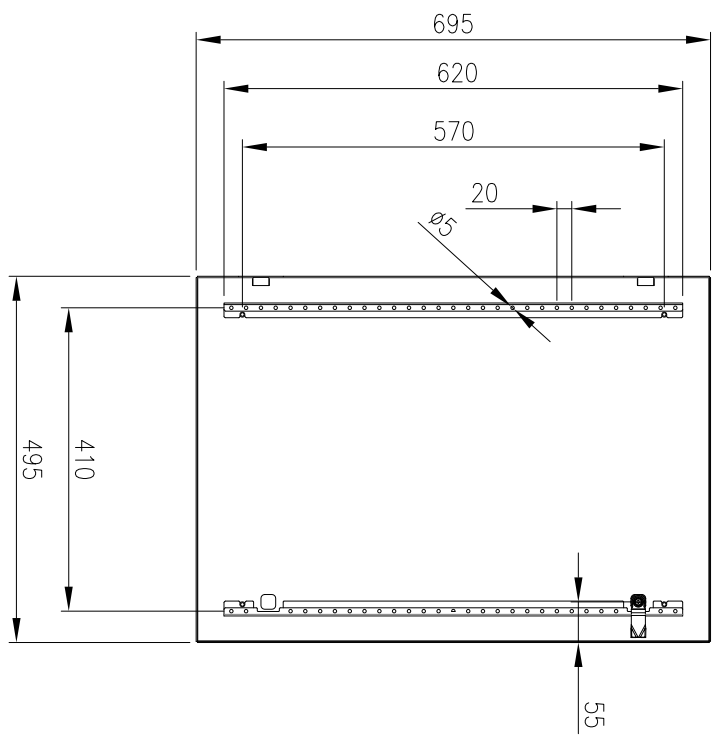

INSIDE DOOR VIEW

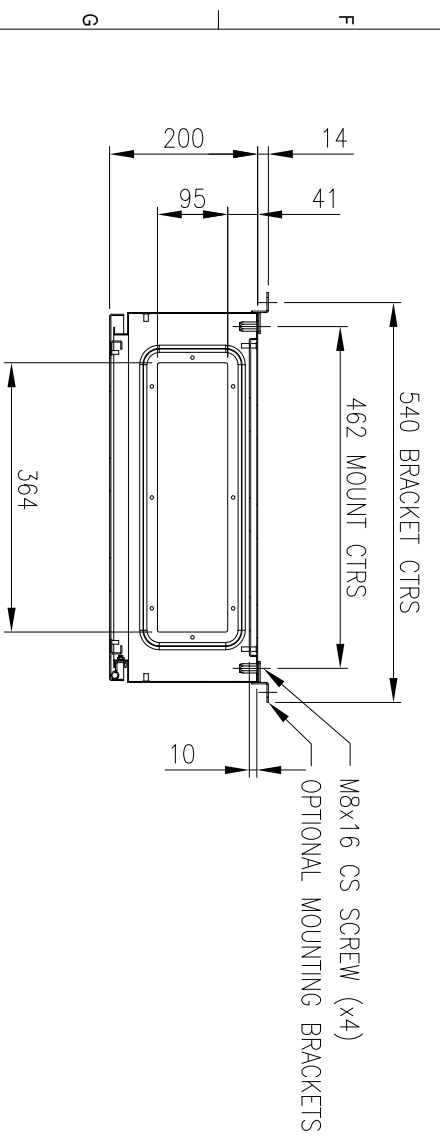

SECTION AW-AW

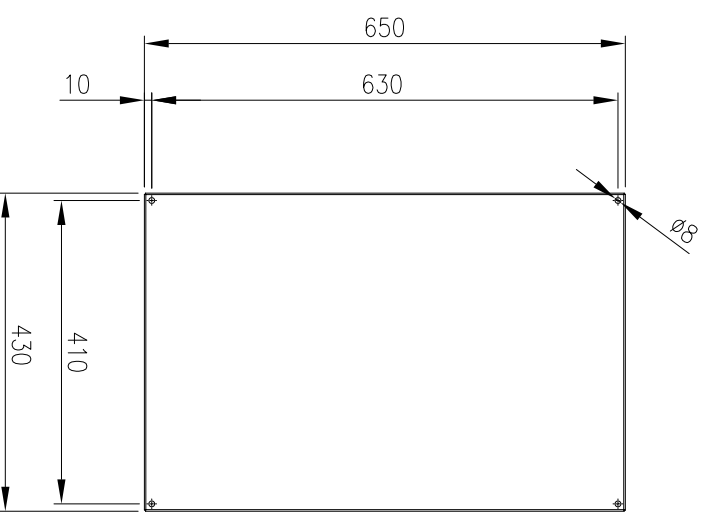

DEVICE MOUNTING PLATE

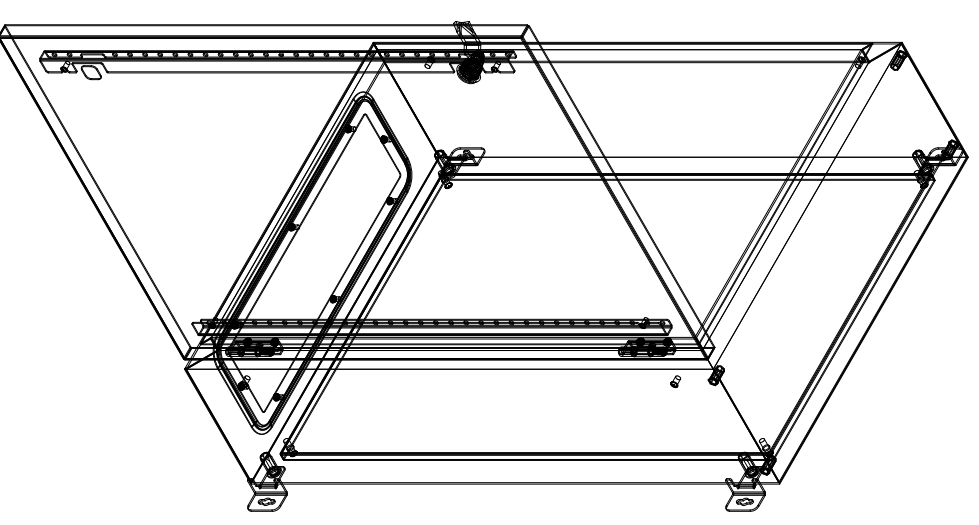

**MATERIAL**  
 BODY: 1.2mm GALVANISED STEEL SHEET  
 DOOR: 1.5mm GALVANISED STEEL SHEET  
 DEVICE PLATE: 1.5mm GALVANISED STEEL SHEET  
 SEAL: POLYURETHANE  
 SURFACE TREATMENT: POWDER-COAT 80-120micron  
 MASS: 17.0kg

PROTECTION: IP66 IK10, NEMA4  
 STANDARD: IEC62208, IEC/EN/AS60529

© IP ENCLOSURES 2016.  
 THIS DRAWING SHALL NOT BE COPIED OR REPRODUCED  
 WITHOUT AUTHORISATION FROM IP ENCLOSURES.  
 www.ipenclosures.com.au

Item#	Quantity	TradeName, designation, material, dimension etc.	Article No./Reference
IP		700x500x200 STEEL ENCLOSURE	

Designed by	Checked by	Approved by - date	Filename	Date	Scale
IP	IP	17/10/16	IP-705020-01	17/10/16	1:10

Item#	Quantity	TradeName, designation, material, dimension etc.	Article No./Reference
IP		700x500x200 STEEL ENCLOSURE	